

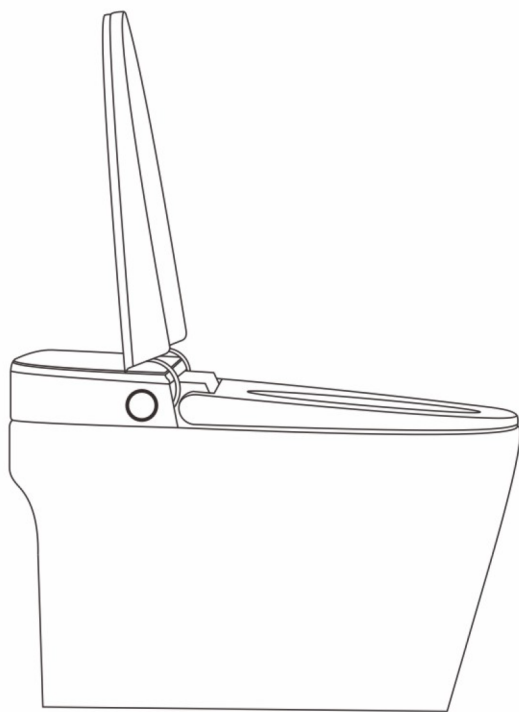

GAOKEJI MATONG 



GM Eco X-Pro1®

The Smartest Toilet
USERS GUIDE

| | |
|--|-------|
| 1. INSTALLATION METHOD | 01~02 |
| 2. COMMISSIONING AFTER INSTALLATION | 03 |
| 3. DESCRIPTION OF SIDE BUTTON PARAMETER SETTING | 04 |
| 4. FUNCTION INTRODUCTION | 05 |
| 5. REMOTE CONTROL PARAMETER SETTING INSTRUCTIONS | 06 |
| 6. VOICE WAKE-UP WORDS AND CONTROL COMMANDS | 07 |
| 7. PRECAUTIONS | 10 |
| 8. COMMON PHENOMENON HANDLING | 11~12 |
| 9. DAILY MAINTENANCE | 13 |

Product Specifications

| | |
|------------------------------|---|
| Product name: GM Eco X-Pro1® | Rated voltage: AC220V~ |
| Product category: Porcelain | Rated frequency: 50HZ |
| Color: White | Rated power: 1300W |
| Grade/QC: Qualified product | Electric shock protection category: Class I |
| Inspection number: QC06 | Water efficiency level: Level 2 |
| Implementation standard: | Pit water distance: 300/400mm |
| GB/T6952-2015 | Others_____ |
| GB 38448-2019 | Nominal water consumption: 5.0L |
| GB 4706.1-2005 | Net weight: 40 (±5) kg |
| GB 4706.53-2008 | Gross weight: 44 (±5) kg |
| GB 6566-2010 | Quantity: 1 piece |

Note: Due to different configurations, the parameter values may vary slightly, please refer to the actual product!

1. INSTALLATION METHOD

REFERENCE DIAGRAM FOR INLET AND OUTLET POSITIONS

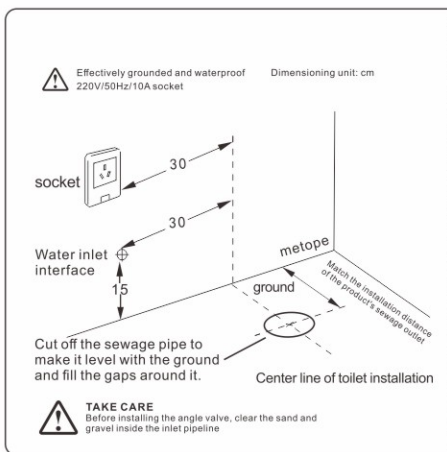

SEALING RING INSTALLATION

Align the oil sludge with the drain outlet and press it firmly in place



FIXED CERAMICS

1. First, clean the ground thoroughly to keep it dry, and conduct a comprehensive inspection of the sewage pipeline to see if there are any mud, waste paper, or other debris blocking the pipeline. At the same time, check whether the installation position of the toilet is level on the front, back, left, and right sides of the ground. If uneven ground is found, the ground should be leveled when installing the toilet.
2. Determine the center of the sewage outlet and draw a cross centerline.
3. Flip the toilet slightly, determine the center on the drain outlet of the toilet, and draw a cross centerline, which should extend to the outer side of the bottom of the toilet.
4. Install the smart toilet vertically and ensure that the cross line on the toilet aligns with the cross line on the ground drain outlet. Use force to press the sludge tightly, and then apply a circle of glass glue around the bottom of the toilet. After installing the toilet, keep it horizontal in front, back, left, and right.



WARN

It is strictly prohibited to fix ceramics with cement, otherwise it may cause ceramic fragmentation. Keep still for 24 hours before use.

1. INSTALLATION METHOD

INSTALLATION OF INLET PIPE

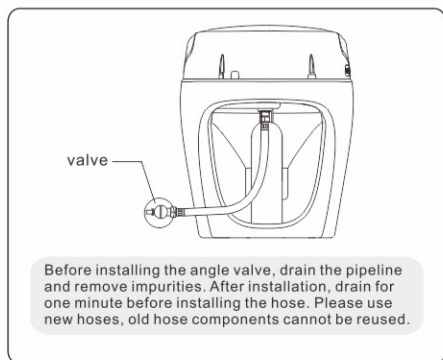

TURN ON ELECTRICITY

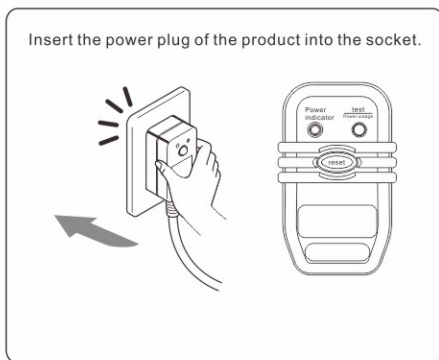

REMOTE CONTROL INSTALLATION

1. INSTALL THE REMOTE CONTROL BRACKET

First, clean the location where the remote control bracket is to be installed, then peel off the back adhesive of the bracket, firmly press it against the wall, and hold it for a period of time before placing the remote control.

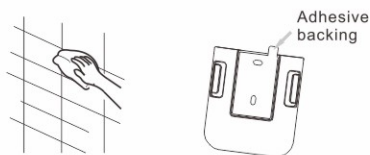

2. BATTERY

Open the battery cover at the bottom of the remote control and correctly place the battery cover on the back cover of the No. 7 battery.

⚠ NOTICE

1. The installation location of the remote control must be confirmed with the user and an appropriate holding distance must be selected.
2. In order to prevent battery rupture, leakage, etc., please be sure to comply with the following terms:
 - When replacing the battery, please use a new battery of the same specification.
 - Please remove the battery when not using it for a long time.
 - When replacing the battery, be careful not to reverse the polarity.



- Do not spill water on the remote control, otherwise the product may not work properly.
- Please place the remote control on the remote control holder when not in use. (Please be careful not to drop the remote control when using it)
- Dropping the remote control may cause malfunction or damage.

2. COMMISSIONING AFTER INSTALLATION

OPEN THE ANGLE VALVE: BEFORE TURNING ON THE POWER, OPEN THE ANGLE VALVE TO PROVIDE WATER FOR THE WHOLE MACHINE.



Note: After opening the angle valve, use a paper towel to dip the pipe connection to confirm that there is no leakage.

VALIDATION AND TEST RUN

1. CHECK WHETHER THERE IS EFFECTIVE GROUNDING

- You need to bring a power polarity line detector to check whether the socket at the customer's home is effectively grounded. This product is not allowed to be used without effective grounding. If the customer forces the use, all consequences will be borne by the customer.



ground

4. CHECK LIGHTING FUNCTION

- Short press the "Lighting" button on the remote control to turn on or off the lighting function.

5. CHECK THE POWER SAVING FUNCTION

- Short press the "Energy Saving" button on the remote control to turn on or off the power saving function.

2. CHECK THE POWER SUPPLY

- Confirm that the power plug is plugged in tightly, press reset, and the indicator light will be on. Press test, the power will be cut off, and the indicator light will go out, indicating that it is normal and can be put into use. Then you can press the "reset" button on the plug to power on. The system buzzer can be heard after power is turned on.

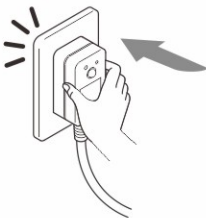

6. CHECK THE HUMAN BODY SEATING SENSOR FUNCTION

- Place wet wipes at the seating sensing position to simulate human sitting. When the system senses that someone is sitting (the buzzer beeps once), the cleaning spray bar will flow water out, and the system function can be activated.

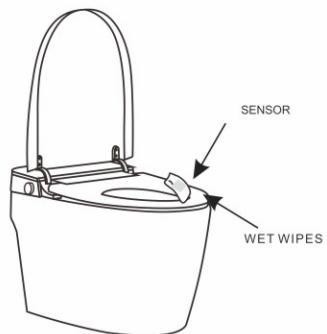

3. CHECK THE SEAT TEMPERATURE ADJUSTMENT FUNCTION

- Short press the seat temperature button on the remote control to adjust the seat temperature.

3、DESCRIPTION OF SIDE BUTTON PARAMETER SETTING

When no one is seated: Turn counterclockwise briefly to turn on the nozzle self-cleaning, and turn clockwise briefly to turn on the ambient light. Press the knob briefly to perform flushing.

When seated: Turn counterclockwise briefly to turn on the women's wash, and turn clockwise briefly to turn on the butt wash. Short press the knob to stop the function or drying.



1. SIDE KNOB SETTING INSTRUCTIONS

1. After long-turning the "butt wash" button for 3 seconds, the system enters the pairing mode, and the display will all flash. At this time, press any button on the remote control, and the toilet will beep 2 times to complete the pairing.
2. Long-turn the "butt wash" button and then press the "stop" button: the radar switch (automatic flip-up) function can be set. The buzzer beeps once long when the function is turned on and short once when the function is turned off.
3. Long-turn the "Waste" button until it beeps once, then press the "Stop" button: the foam shield switch function can be set. The buzzer beeps once long when the function is turned on and short once when the function is turned off.
4. Long-turn the "Stop" button to turn off the machine, then turn the "Butt Wash" button for a long time and then press the "Stop" button: the system enters the aging mode.

SHORT PRESS TO CORRESPOND TO THE FUNCTION OF EACH BUTTON

2. SIDE BUTTON SETTING INSTRUCTIONS

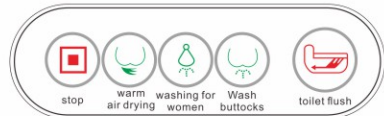

1. Long press the "drying" button: you can set the foam shield switch function. The buzzer beeps once long when the function is turned on and short once when the function is turned off.
2. Press and hold the "Women's Wash" button: you can set the automatic flushing switch function. The buzzer beeps once long when the function is turned on and short once when the function is turned off.
3. Long press the "butt wash" button: the system enters the code matching mode, and the display will all flash. At this time, press any key on the remote control to perform code matching. After the code is successfully matched, the display will return to normal display status.
4. Press and hold the "Stop" button: Press and hold the "Stop" button for the first time, the buzzer will sound, and the radar range setting state will be entered. At this time, you can press the "Buttocks" or "Women's Wash" button on the side or Move the nozzle forward and backward on the remote control to adjust the sensing distance of the radar. At the same time, the water temperature display area of the display will display the corresponding radar setting gear (range is 1~5). After the adjustment is completed, short press "Stop" again. " button will return to the screen displaying the set water temperature. If the radar gear is not adjusted within 10 seconds, it will automatically exit the radar gear adjustment state after 10 seconds and the screen will resume displaying the set water temperature.

Note: Level 1 has the shortest sensing distance, and Level 5 has the farthest sensing distance.

5. Press and hold the "Butt Wash" button and the "Drying" button at the same time: the system enters the aging mode.
6. Long press the "flush" button: Press and hold the "flush" button for the first time, the buzzer will sound once, and you will enter the flush time setting state. At this time, you can use the remote control to set the flush time. "Move nozzle forward" or "move nozzle back" keys to adjust the flushing time. At the same time, the water temperature display area of the display will display the current setting stage, seat temperature. The display area shows the flushing time. Press the "flush" button again to switch to the next stage of flushing time setting. The three stages are upper flushing, Flush and replenish water. After the setting is completed, press the "flush" button again to exit the setting state.
7. Short press the power saving button to turn on energy saving.

4、FUNCTION INTRODUCTION

| | |
|----------------------------------|--|
| Buttocks cleaning | When sitting down, turn the side knob clockwise or press the butt wash button on the remote control to turn on the butt wash function. |
| feminine cleansing | When sitting down, turn the side knob clockwise or press the bidet wash button on the remote control to turn on the bidet wash function. |
| position adjustment | During the cleaning process, you can short press the 2 buttons on the remote control to adjust. |
| mobile cleaning | During the cleaning process, you can short press the corresponding button to start mobile cleaning. (When washing the buttocks, press briefly to wash the buttocks; when washing the vagina, press the button briefly to wash the woman) |
| Water pressure adjustment | During the cleaning process, you can short press the 2 buttons of the remote control to adjust the water pressure. |
| Water temperature adjustment | You can short press the water temperature button on the remote control to adjust the water temperature. (Display 00 is normal temperature, no heating) |
| warm air drying | When sitting down, short press the side knob or short press the drying button on the remote control to turn on the drying function. |
| Air temperature adjustment | You can short press the air temperature button on the remote control to adjust the air temperature. (Display 00 is normal temperature, no heating) |
| Seat heating | When sitting down, short press the side knob or the seat temperature button on the remote control to turn on the drying function. |
| Seat temperature adjustment | You can short press the seat temperature button on the remote control to adjust the seat temperature. (Display 00 is normal temperature, no heating) |
| Seating sensor | After the human body sits down, it automatically senses that the toilet is ready for use. |
| Flushing during power outage | Even if the water supply is not cut off, it can be flushed during a power outage without affecting the use of the toilet. |
| Flush without sitting | After the user leaves the seat, the toilet will automatically start flushing. |
| Take a seat and moisten the wall | When the human body takes a seat, a section of water will be sprayed to moisten the inner wall of the toilet. |
| Intelligent diagnosis | Diagnose and provide prompts for abnormal phenomena in the toilet bowl from time to time. |
| remote control | Use the remote control to remotely control the corresponding functions of the toilet. |
| night light lighting | Equipped with a night light, when turned on, it emits soft light for easy use at night. |
| Boom cleaning | The spray boom extension function can be activated for manual cleaning and deeper cleaning of the spray boom. |
| Smart power saving | When energy-saving is turned on, the seat temperature will drop to 30 degrees before sitting down, and the screen will automatically turn off the ambient light knob light if no operation is performed for 5 minutes. |
| Self-cleaning nozzle | After the seating and disengagement are effective, the nozzle automatically sprays strong water flow to clean the nozzle. |
| Silent and slow descent | The seat ring and seat cover fall slowly to prevent making noise when landing. |
| digital display | Use numbers to display temperature and icons to display function status, allowing you to understand usage requirements more intuitively. |
| Leakage Protection | The product is equipped with a leakage protection device. When a leakage fault occurs in the product, the power supply will be cut off before the human body senses anything to protect personal safety. |
| Low temperature protection | When the sitting temperature is set to heating, after the human body sits down, the seat temperature automatically enters a specific control program to prevent low-temperature burns. |
| Radar sensing | When a person approaches the toilet, the lid will automatically open. |
| kick flush | When you kick the kick sensor of the product, the smart toilet automatically flushes. |
| Kick and turn | When you kick the kick sensor of the product, the smart toilet will automatically turn around. |
| bubble guard | After turning on this function, the toilet will automatically spray a layer of fine bubbles to cover the water seal, which can effectively inhibit bacteria and odor, and prevent water splashing. |
| Voice intelligent control | Through the set instructions, human-machine dialogue can be carried out, and the corresponding functions of the toilet can be turned on by speaking. |
| No water pressure limit | The product has a built-in water tank and pump pressure system, which is not affected by the amount of external water on the flushing effect. |
| Mobile phone intelligent control | After connecting to the mobile phone applet via Bluetooth, you can use the mobile phone interface to turn on the corresponding functions of the toilet. |
| Side buttons | There are multi-function buttons on the side of the product. If the remote control is out of power or malfunctions, the product can still be used. |
| Colorful knobs | The knob designed on the side of the product has different colors for different functions, making it easy to operate. |

✳️ Note: Products or configurations of different periods correspond to different functions, please refer to the actual product received.

5、REMOTE CONTROL PARAMETER SETTING INSTRUCTIONS

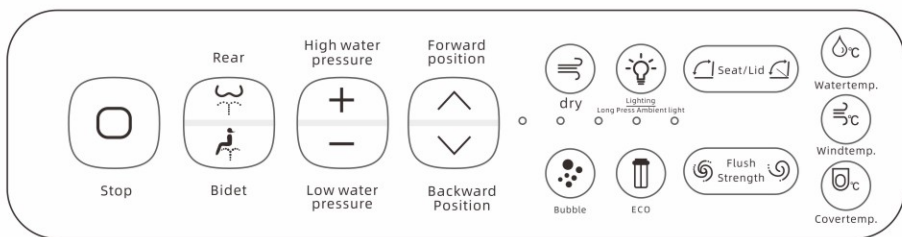

Note: For reference only, please refer to the actual remote control

2. REMOTE CONTROL SETTING INSTRUCTIONS

- Press and hold the "butt wash" button on the remote control for about 5 seconds: you can set the radar switch (automatic flip) function. When the function is turned on, the buzzer beeps once. The buzzer beeps briefly when the function is turned off.
- Press and hold the "Women's Wash" button on the remote control for about 5 seconds: you can set the automatic lid closing and flushing switch function. When the function is turned on, the buzzer beeps once. The buzzer beeps briefly when the function is turned off.
- Press and hold the "Drying" button on the remote control for about 5 seconds: the automatic foam shield switch function can be set. When the function is turned on, the buzzer beeps once. The buzzer beeps briefly when the function is turned off.
- Press and hold the "flush" button on the remote control for about 5 seconds: you can set the automatic flushing switch function when leaving the seat and closing the lid. When the function is turned on, the buzzer beeps once. The buzzer beeps briefly when the function is turned off.
- Press and hold the "water temperature" button on the remote control for about 5 seconds: you can set the wall moisturizing switch function. Beep when function is on. The buzzer beeps briefly when the function is turned off.
- Press and hold the "Air Temperature" button on the remote control: Press and hold the "Air Temperature" button for the first time, the buzzer will sound, and you will enter the radar distance gear setting state. At this time, you can adjust the radar's sensing distance through the "Nozzle Move Forward" and "Nozzle Move Back" keys on the remote control. At the same time, the water temperature is displayed on the display. The area will display the corresponding radar setting gear (range is 1-5). After the adjustment is completed, short press the "Stop" key again to exit the setting state. If the radar gear is not adjusted within 10S, it will automatically exit the setting state after 10S.

Note: Level 1 has the shortest sensing distance, and Level 5 has the farthest sensing distance.

- Press and hold the "Seat Temperature" button on the remote control: Press and hold the "Seat Temperature" button for the first time, the buzzer will sound, and you will enter the flushing time setting state. At this time, you can adjust the flushing time through the "Nozzle Move Forward" or "Nozzle Move Back" keys on the remote control, and at the same time, the water temperature display area on the display screen. The current setting stage will be displayed, and the seat temperature display area will display the flushing time. Press and hold the "seat temperature" key again to switch to the next stage of flushing. Water time setting, the three stages are 1 up flush, 2 down flush, 3 water replenishment, 4 wall moistening. After the setting is completed, long press the "seat temperature" button again. Then exit the setting state.
- Press and hold the "Flip and Turn" button on the remote control for about 5 seconds: the buzzer will sound 3 times continuously, and you can enter the flip-turn opening angle learning function.
 - At this time, the display will display the set virtual angle, with the cover on the left as a circle and the right as a circle. After 5 seconds, it will switch to display the real-time virtual angle;
 - Move the lid with your hand to adjust the digital change, and press the "Position <" key on the remote control to learn the lid opening angle;
 - Use your hand to move the seat ring to adjust the digital change, and press the "Position >" button on the remote control to learn the seat ring opening angle;
 - Press the stop button on the remote control to exit.

Note: After closing the cover and seat and then turning on the power, the system will automatically learn the closing angle without adjustment.

- Press and hold the "Move >" button on the remote control for about 5 seconds: you can set the automatic sterilization switch function. When the function is turned on, the buzzer beeps once. The buzzer beeps briefly when the function is turned off.
- Press and hold the "water pressure -" button on the remote control for about 5 seconds: start the small flush.
- Press and hold the "Position □" key or "Cleaning Position □" on the remote control for about 5 seconds: the automatic infrared physiotherapy switch function can be set. The buzzer beeps once long when the function is turned on and short once when the function is turned off.
- Short press the "Power Saving" button or long press the "Lighting" button for about 5 seconds: you can set the energy saving switch. When it is turned on, the buzzer will sound a long time. The buzzer beeps briefly when the function is turned off.

- Long press the "Power Save" button on the remote control for about 5 seconds or short press the "Bubble" button: you can manually start the foam shield to foam.
 - Press and hold the "water pressure +" button or "bubble" button on the remote control for about 5 seconds: you can manually start the nozzle self-cleaning.
 - Press and hold the "Stop" button on the remote control for about 5 seconds: you can manually set the system to turn on and off.
PS: When the energy-saving function is turned on, the seat temperature will drop to 30 degrees before sitting down, and the screen will automatically turn off the ambient light knob light if no operation is performed for 5 minutes.
- PS: During the power-on process, press the stop button three times in succession, the sound will beep three times, and the factory default settings will be restored.

Before taking a seat, short press the wash button to manually turn on ultraviolet sterilization. While seated, press the bright button to start manual infrared physiotherapy.

Fault indication: Indicate component fault status through the number of flashes of the night light/or the display screen

| | | | | | |
|----------------------------------|---------------------|--|---------------------|---|---------------------|
| Water temperature sensor failure | E1 Flash 1 time | Instant thermal module overheat protection | E6 Flash 6 time | Instant hot module strong current failure | E9 Flash 9 time |
| Seat temperature sensor failure | E2 Flash 2 times | Water heater failure | E7 Flash 7 times | Instant hot module communication failure | E4 Flash 4 times |
| Drying fan failure | E3 Flash 3 times | Cleaning water shortage problem | E8 Flash 8 times | Ambient temperature sensor failure | E5 Flash 5 times |

6、VOICE WAKE-UP WORDS AND CONTROL COMMANDS

| This is your toilet assist, wake me up by TT | | |
|--|---|-----------------------|
| Wake word | Command word | Function/Announcement |
| | hey toilet, hey ToyTe, hey TT | yes |
| | volume up | volume up |
| | volume down | volume down |
| | seat open, seat up | seat open |
| | seat close, seat down | seat close |
| | cover open, cover up | cover open |
| | cover close, cover down | cover close |
| | flush water, clean toilet, flush toilet | toilet clean |
| | water stop, flush stop, clean stop | clean stop |
| | dryer on | dryer on |
| | dryer off | dryer off |
| | light on | light on |
| | light off | light off |
| | water temperature up, water hot | water hot |
| | water temperature down, water cold | water cold |
| | dryer temperature up, dryer hot | dryer hot |
| | dryer temperature down, dryer cold | dryer cold |
| | seat hot, seat temperature up | seat hot |
| | seat cold, seat temperature down | seat cold |
| | spray front, spray up | spray up |
| | spray back, spray down | spray down |
| | water more | water more |
| | water less | water less |
| | back clean, bottom clean | back clean |
| | front clean, lady clean | front clean |
| | auto clean | auto clean |
| | child mode, easy mode, simple mode | easy mode |
| | spray clean | spray clean |
| | spray move | spray move |
| | spray stop | spray stop |
| | bubble on, bubble open | bubble on |
| | bubble off, bubble close | bubble off |
| | spa A on, spa A open, spa A start | spa A on |
| | spa A off, spa A close, spa A stop | spa A off |
| | volume on | volume on |
| | volume off | volume off |
| | spa B on, spa B open, spa B start | spa B on |
| | spa B off, spa B close, spa B stop | spa B off |

7、PRECAUTIONS

Please read this section carefully. The precautions listed here are important safety-related contents and must be followed. The logo and description are as follows:





warn

Indicates that if this sign is ignored and misuse is performed, serious injury or other accidents may result.





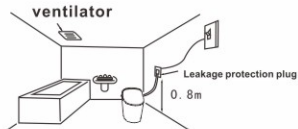
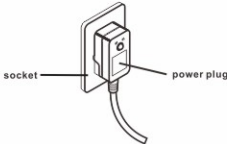



Notice









Indicates that if you ignore this sign and operate incorrectly, personal injury or property damage may occur.

| | | |
|--|--------------------------------------|--|
| NOTICE | Disassembly is prohibited | <p>Never disassemble or modify the product Otherwise it may cause fire, electric shock and damage due to abnormal movement.</p> |
| | No splashing of water | <p>Do not pour water on the product body and power plug. otherwise it may cause fire or electric shock.</p>  |
| | MUST BE OBEYED | <p>This product is an electrical product, so please do not place it in a place that is easily splashed by water or has high humidity. When using it in the bathroom, please install a ventilator fan to maintain good air circulation in the bathroom. Otherwise it may cause fire or electric shock.</p> |
| | | <p>Please set the socket for power wiring as follows. Failure to follow the following requirements may cause a fire. 1. The load of the socket must be greater than 2KW; 2. The socket should be installed more than 0.8m above the ground and as far away from the bathtub or rain shower as possible.</p>   |
| | | <p>Do not use loose or faulty sockets as this may cause fire or electric shock.</p> |
| <p>The grounding wire of this product has been grounded. Please be sure to connect it to the grounding wire. If it is not grounded, it may cause electric shock in the event of malfunction or leakage. Please make sure the power plug is plugged into the AC 220V/50Hz socket. Otherwise, it may cause machine failure or fire due to heat. The sequence of phase wires, neutral wires and ground wires in the power socket must be correct</p>  | ground | |

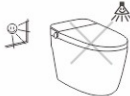
7、PRECAUTIONS

| | |
|---|--|
|  MUST BE OBEYED | <p>BE CAREFUL ABOUT LOW TEMPERATURE BURNS</p> <ol style="list-style-type: none"> When sitting on the seat for a long time, please adjust the temperature of the seat to normal temperature. When the following people use it, please adjust the seat temperature to normal temperature. <ul style="list-style-type: none"> •Children, the elderly and other people who cannot adjust the temperature to a suitable level by themselves; •Sick people, disabled people and other people with limited mobility; •Drowsy people who have taken sleep-inducing drugs (such as sleeping pills, cold medicine, etc.), drank heavily, and were overtired. |
| | <p>Make sure the power plug is inserted in place If it is not fully inserted, it may cause electric shock or heat, resulting in a fire. Be sure to disconnect the power supply when cleaning.</p> |
|  NOTICE  PROHIBIT | <p>Do not insert or unplug the power plug with wet hands. otherwise it may cause electric shock.</p>  Prohibition of wet hands |
| | <p>DO NOT CONTINUE TO USE THE PRODUCT IF IT MALFUNCTIONS</p> <ol style="list-style-type: none"> In the following situations, please unplug the power plug and close the water inlet angle valve <ul style="list-style-type: none"> so-called malfunction <ul style="list-style-type: none"> •Water leaks from water pipes and inside the product •Unusual sounds and strange odors occur •The product is abnormally hot •Cracks appear on the product •The product smokes •The toilet is clogged If you continue to use it when it is faulty, it may cause fire, electric shock, indoor water seepage and other problems. |
| | <p>Do not damage or replace the power cord, power plug and connecting cable without permission</p> <p>Do not scratch, process, place near high temperatures, forcibly bend, twist, stretch, place heavy objects on, or bundle.</p> <ol style="list-style-type: none"> If it is still used if it is damaged, it may cause electric shock, short circuit, or fire; The power cord of this product adopts Y-shaped connection. If the power cord is damaged, it must be replaced by our company or a professional service personnel authorized by our company. |
| | <p>Do not use water sources other than tap water</p> <ol style="list-style-type: none"> Otherwise it will cause problems such as dermatitis; If foreign matter is mixed in and accumulated in the piping, it may cause malfunction. |
| | <p>Patients with pacemakers should not use this product Otherwise, electromagnetic interference will be generated, resulting in damage to the pacemaker function and life-threatening consequences.</p> |
| | <p>Do not put lit cigarettes into the toilet or place hot or flammable objects near the toilet Otherwise it may cause fire.</p>  High temperature prohibited |
| <p>This appliance should not be used by persons (including children) with reduced physical, sensory or mental capabilities, or lack of experience and knowledge. Unless they have been supervised or instructed in the use of the product by a person responsible for safety. Do not let children play on the seat ring or seat cover, and do not step on or sit on the seat cover. Otherwise, it may cause malfunction and safety accident.</p>  | |

7、PRECAUTIONS

| | |
|---|---|
|  <p>PROHIBIT</p> | <p>Do not lean back on the seat cover Otherwise, the seat cover will be damaged.</p>  |
| | <p>Do not leave the product under strong light or direct exposure to sunlight for a long time. Otherwise, the plastic parts will become discolored and the temperature of the seat ring will be unstable.</p>  |
| | <p>Do not bend, twist or damage the water supply hose Otherwise, water leakage may occur due to loose connections.</p> <p>When closing the seat cover and seat ring, do not use excessive force, otherwise the product may be damaged.</p> |
| | <p>Do not use the toilet to flush anything other than excrement and toilet paper Otherwise, the toilet will be clogged, sewage will flow out and indoor water will seep.</p> |
| | <p>When taking out the filter screen of the angle valve, the angle valve must be closed first, otherwise water leakage will occur. Once the filter screen of the angle valve is taken out, it must be tightened when reinstalling it, otherwise it will cause water leakage.</p> |
| | <p>When the toilet is clogged, first cut off the power, and then use a commercially available pipe dredge to clear it. If the power is not cut off, the automatic flushing will continue to work, which may cause sewage overflow, indoor water seepage, etc.</p> |
| | <p>When the room temperature in the bathroom is low (zero degrees Celsius and below), please increase the indoor temperature Otherwise, the water pipes and the internal parts of the product may be damaged due to freezing, resulting in water leakage.</p> |
| | <p>Do not wipe the product body with dry cloth or toilet paper, otherwise it may cause scratches on the product.</p> |
| | <p>Do not use it when there is a power or water outage, otherwise the product functions will not be implemented and use will be affected.</p> |
| | <p> NOTICE</p> <p> MUST BE OBEYED</p> |
| <p>Do not pour urine on the toilet body and nozzle Failure to do so may cause malfunctions or stains such as pink and brown.</p>  | |
| <p>During thunder, please unplug the power plug, otherwise it may cause malfunction.</p>  | |
| <p>When traveling or not using it for a long time, please cut off the water and circuit, otherwise it may cause safety accidents.</p>  | |

8、COMMON PHENOMENON HANDLING



WARN

Except for maintenance technicians, please do not disassemble, repair, or modify on your own.
(May cause fire or electric shock)

When the product works abnormally, please confirm the following items. If it still cannot be eliminated, please contact our company or the local after-sales service department.

1: BODY

| Phenomenon | Confirmation matters | deal with |
|---------------------------|--|--|
| Can't turn on the machine | Is there a power outage? | Please wait until power is restored |
| | Is the power plug plugged in properly? | Please insert the power plug into the socket |
| | Is the power turned off? | Please turn on the power |

2: WASH BUTTOCKS, WASH FOR WOMEN

| Phenomenon | Confirmation matters | deal with |
|---------------------------------|---|--|
| Cannot spray water | Whether to cut off water | Please wait until the water cutoff is lifted |
| | Is the angle valve closed? | Please open the angle valve |
| | Is the nozzle blocked by foreign matter? | Please clean the nozzle |
| | Is the human body sitting sensor switch in action? | Please adjust your sitting posture |
| Water temperature is not enough | Is the gear level too low? | Please reset the water temperature |
| | Whether it is set to "no heating" state | |
| Water cut off midway | Whether it will automatically stop when the cleaning time is up | Please activate the cleaning function again |
| | Is the human body sitting sensor switch in action? | Please adjust your sitting posture and restart |
| low water pressure | Is the water pressure strength at a weak position? | Please reset the water pressure |
| | Is the filter clogged? | Please clean the water inlet filter part |
| | Is the water pipe broken? | Restore pipeline status |

8、COMMON PHENOMENON HANDLING

3: DRYING FUNCTION

| phenomenon | Confirmation items | handle |
|--------------------------|--|---|
| Low warm air temperature | Is the gear too low | Please reset the air temperature |
| | Is it set to the "no heating" state | |
| Warm air stops midway | Is it automatic stop when the drying time is up | Please restart the drying function |
| | Is there any action of the human seat induction switch | Please adjust your sitting position and restart |

4: SEAT HEATING

| phenomenon | Confirmation items | handle |
|-------------------------------|--------------------------------------|---------------------------------|
| Insufficient seat temperature | Is the power-saving function enabled | Exit power-saving function |
| | Is the gear set too low | Reset the seat ring temperature |

5: AUTOMATIC FLUSHING

| phenomenon | Confirmation items | handle |
|------------------------------------|---|--|
| Not automatically flushed | Whether to stop water supply | Please wait until the water cut is lifted |
| | Is the angle valve closed | Please open the angle valve |
| | Is the angle valve blocked | Please clean the angle valve filter screen |
| | Is the seating time shorter than 10 seconds | Please sit for more than 10 seconds |
| Power outage unable to flush water | Is the backup battery connected | Connect the backup battery |
| | Is the backup battery charged | Replace the backup battery |

9、 DAILY MAINTENANCE

WARN

Before cleaning the surface of the product, please make sure to cut off the power supply.
Do not allow water or cleaning agents to flow into the interior of the product or onto the power plug.

- May cause electric shock, short circuit, fire.



Compulsory compliance

1. NOZZLE CLEANING

When powered on and the human body is away from the seat, short press the "wash" button on the remote control to activate the spray cleaning function. This wiping button can also be turned on in a counterclockwise direction. When the function is turned on, the spray rod will extend and be gently wiped with a soft cloth or toothbrush. Finally, press the "stop" button on the remote control to clean.



- Do not press or pull the nozzle forcefully, otherwise it may cause damage or malfunction.

2. CUT OFF THE POWER SUPPLY

Be sure to cut off the power before cleaning the product body.

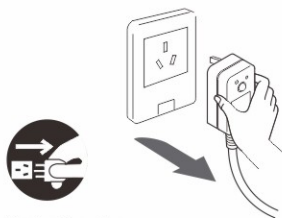

Unplug the plug

3. WIPE WITH A SOFT CLOTH SOAKED IN WATER AND WRUNG DRY

Difficult to clean dirt can be wiped with diluted neutral detergent. Do not use acidic or alkaline detergents, detergents, gasoline diluents, or other cleaning products.

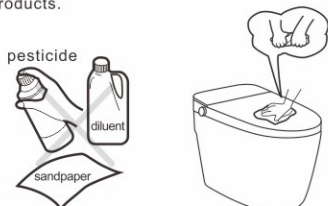

4. CLEAN THE FILTER SCREEN

When users feel that the water flow is less than normal during use, they should first close the angle valve, then dismantle the filter screen in the angle valve (can be twisted with a one yuan coin), and clean the filter screen under the faucet with a brush. During the cleaning process, the filter screen must be thoroughly separated from the water supply hose.

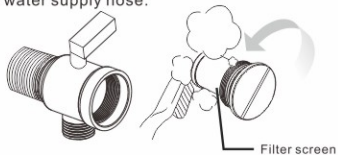

Thank you for choosing our company's smart toilet.
Please carefully read this manual and keep it safe
for proper use. Before use, be sure to read it carefully.
※ Note: This manual contains after-sales service guidelines